

REV.	BY	DATE	APPRVD.	P/N	VK21-228-T
A	AT	10-09-01		BRACKET WAS 4"	

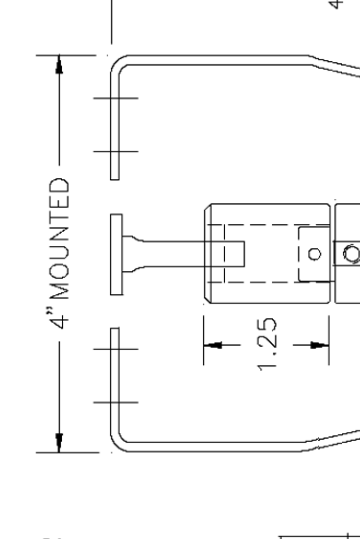

MATERIAL:
 BODY ----- SS
 STEM ----- SS REGULATING
 SEAT ----- SOFT SEAT REGULATING
 SEALS ----- TEFLON
 BRACKET -----
 ALUMINUM ANODIZED
 COUPLER -----
 BRASS, NICKEL PLATED
 SET SCREWS & PINS
 ARE STAINLESS STEEL

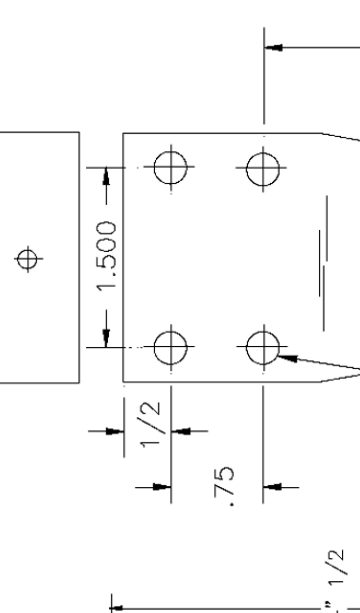

ROTATIONAL LIFE CAN DEPEND ON MANY VARIABLES, SUCH AS, SEAL TYPE, PRESSURE DROP, TYPE OF GAS OR FLUID METERED, DUTY CYCLE, ETC.

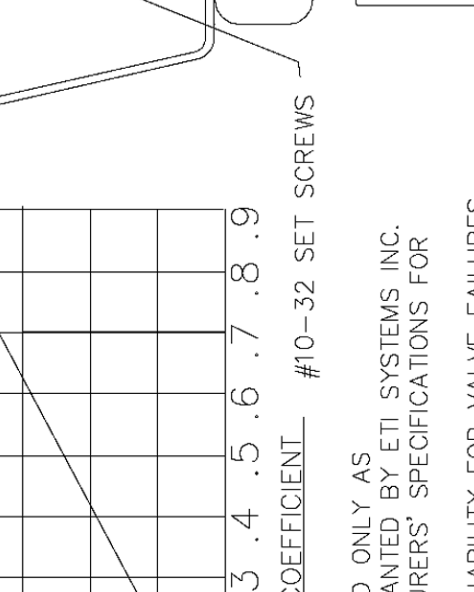

NOTE:
 ALL VALVE DATA IS OFFERED ONLY AS GUIDELINES AND IS NOT WARRANTED BY ETI SYSTEMS INC. CHECK THE VALVE MANUFACTURERS' SPECIFICATIONS FOR PERFORMANCE CRITERIA.
 ETI SYSTEMS ASSUMES NO LIABILITY FOR VALVE FAILURES. (SEE ETI SYSTEMS TERMS AND CONDITIONS FOR ACTUATOR LIABILITY LIMITATIONS)

VALVE TYPE ----- NEEDLE	MODEL ----- SS-6NKRVC08	MANUFACTURE ----- WHITE	ORIFICE ----- .250	CV ----- .86	FITTINGS ----- 1/2 MALE VCO	MAX. PRESSURE ----- 6000 PSIG	TEMPERATURE RANGE ----- -53°C TO +93°C
<p>FLOW COEFFICIENT #10-32 SET SCREWS</p>							
<p>ETI SYSTEMS CARLSBAD CALIFORNIA</p>							
<p>VALVE KIT</p>							
<p>PART NO. VK21-228-T</p>							